

Quick Start

Tank Liner Installation Instructions

Instructions for 5 Gallon (PN T10015) & 10 Gallon (PN T15337) Liner

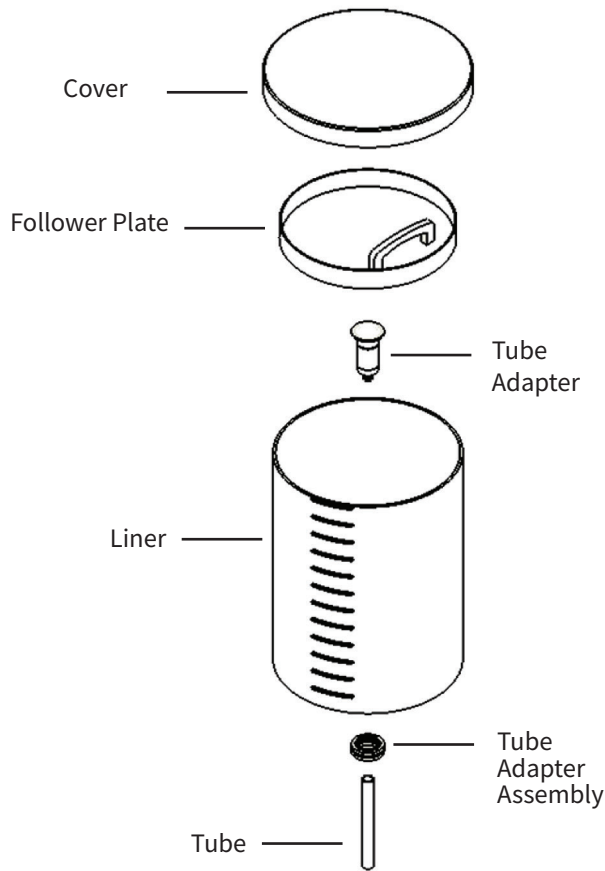

Figure 1. Liner Assembly

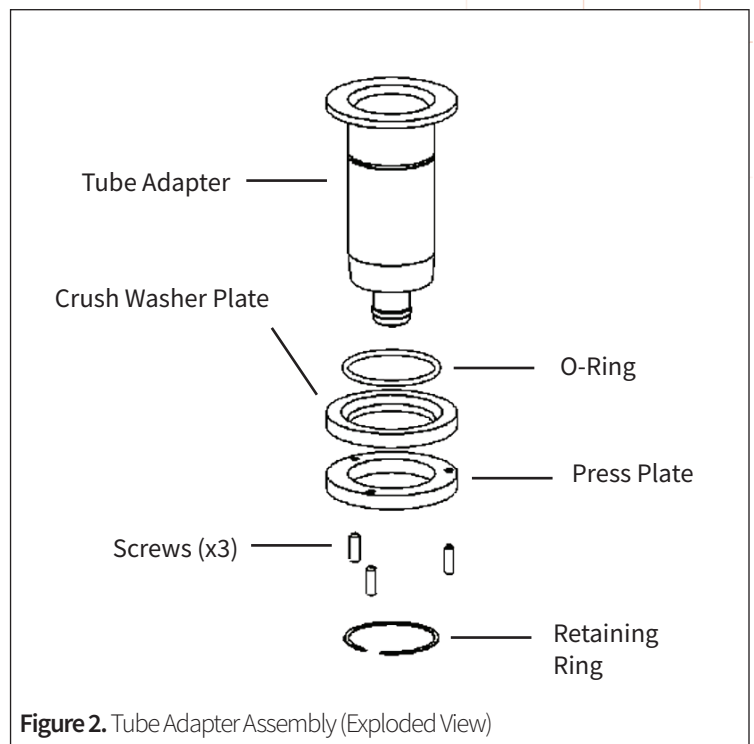

Figure 2. Tube Adapter Assembly (Exploded View)

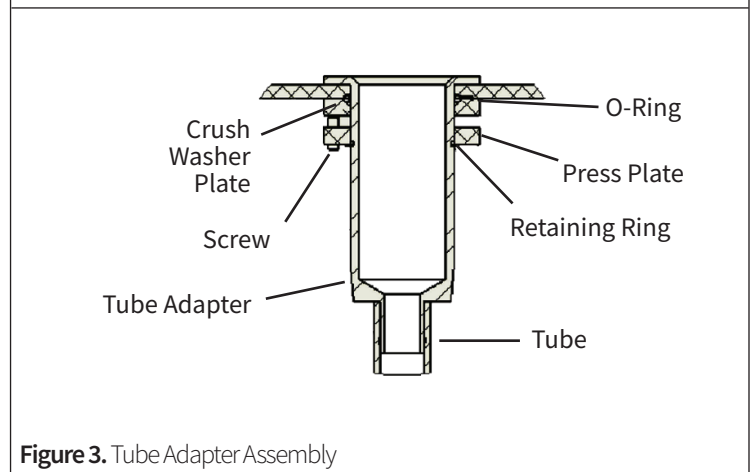

Figure 3. Tube Adapter Assembly

Attaching the Tube Adapter Assembly on the Liner

1. Carefully unwrap the components of the Liner Assembly (Figure 1) and verify that all the pieces are present.
2. Insert the Tube Adapter into the hole located at the bottom of the Liner. The Tube Adapter body should pass through the hole and hang out of the Liner, while the top lip of the Tube Adapter prevents the piece from passing all the way through.
3. From the underside of the Liner, place the O-Ring over the Tube Adapter. The O-Ring will be flush up against the underside of the Liner.
4. From the underside of the Liner, place the Crush Washer Plate over the Tube Adapter. Note the orientation of the Crush Washer Plate. This plate will be pushed flush with the underside of the Liner (Figure 3).
5. From the underside of the Liner, place the Press Plate over the Tube Adapter. For now, the Press Plate should be held up against the Crush Washer Plate.
6. Place the Retaining Ring into the grooves on the Tube Adapter. The Retaining Ring will prevent the O-Ring, the Crush Washer Plate, and the Press Plate from slipping off the Tube Adapter.
7. Fasten the Screws into the Press Plate. As the Screws are inserted, they will travel through the Press Plate and push the Crush Washer Plate against the O-Ring and the underside of the Liner. Tighten the Screws until they hold the Crush Washer Plate against the Liner.

Note: *It is important that these Screws are tightened evenly to create an air tight seal against the Liner.*